

User Manual

CH-100 cooling and heating mat

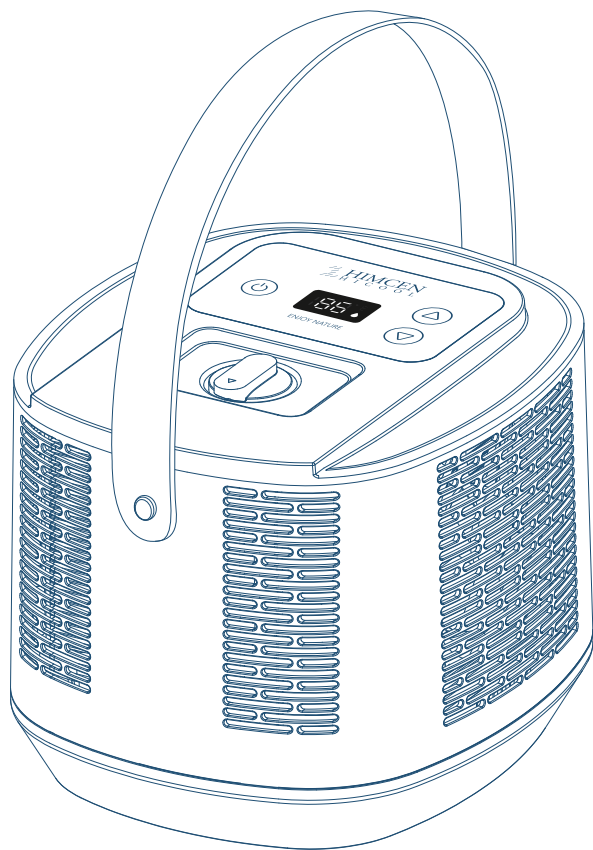

CATALOG

- what' s included (P02)
- Product description (P03)
- Technical data (P04)
- How to Use (P05-P06)
- keys presentation (P07)
- How to pair RC (P08)
- Use tips (P09)
- How to fill water (P10)
- Safety Instructions (P11)
- Precautions & Warranty (P12)

What's included



Control unit

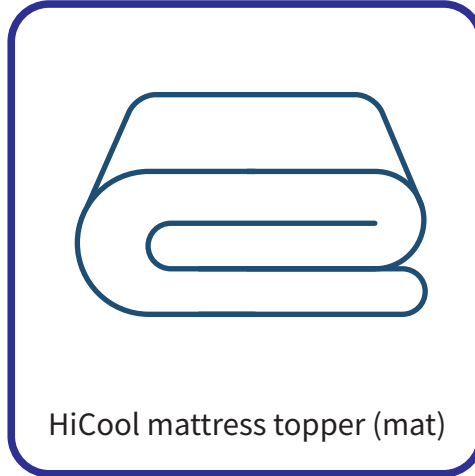

HiCool mattress topper (mat)



Remote control

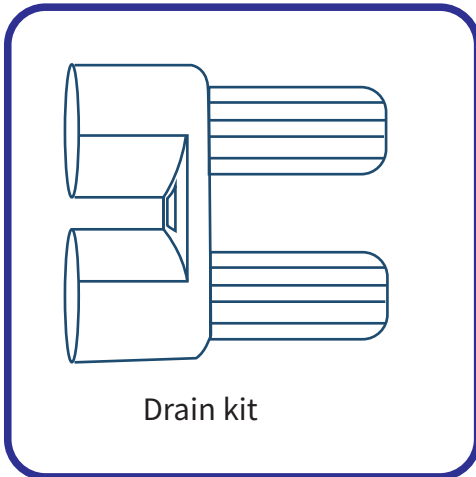

Drain kit

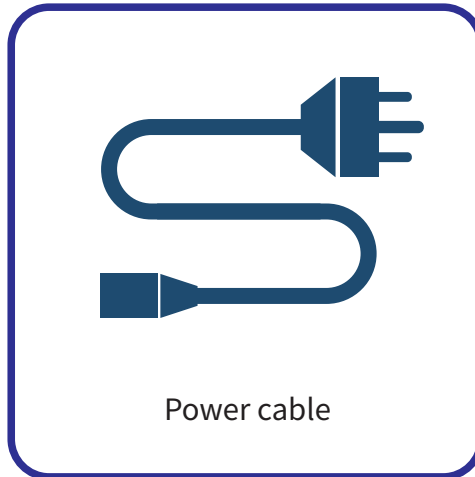

Power cable

Product description

1.HiCool cooling and heating system is a new technology, which adopts external heating and cooling water circulation system, water and electricity separation technology. No fire hazard, no resistance wire, no electromagnetic radiation, and equipped with the unique water shortage alarm; protection of leakage, fan blocking, dry burning and other safety protections. It also has the effect of physical therapy and health care.

2.Using semiconductor thermoelectric TEC cooling and PTC heating technology , this sleeping product has the advantage of no noise , no vibration , and with reliable performance . It also uses the water circulation system , to achieve constant temperature control and smaller power consumption . The water temperature inside the mat is even , and it has a unique water shortage alarm system which makes the service life of the product longer.

3.This product with automatic temperature control , it can be set to any temperature within the range . With cold or hot water circulation inside the mat , separation of water and electricity , makes it safe to use and friendly to the environment . Even if the mat is sprayed with water , there will be no safety issues with the system.

4.The product quality is reliable and durable, with a long service life.

Technical data

Item	Parameter
Rated voltage	100- 240V ~
Rated Frequency	50/60Hz
Rated power (heating or cooling)	155W
Water tank Volume	~400ml
Water tube volume in mat	900ml (0.9m width)

How to Use

- 1 . Unfold the HiCool mat and place it on the bed or in a tent , mind that the pad cannot be folded when in use.
- 2 . Set the control unit on a flat surface, the height difference between the surface and your bed is no more than 50cm . Please make sure there is at least 30cm of space at every side of the Control Unit for heat dissipation . (Note : Make sure to install the joint correctly) . See figure 1.
- 3 . Plug the power cable into the control unit , and then into a wall outlet . See figure 2.

How to Use

4 . Unscrew the top cap of the control unit and fill with water until full . See figure 3
(Note : It is recommended to use clean water which is benefit for the product life).

5 . Full filled water into the water tank, then turn on the power of the control unit, the water pump begins to fill the Hydronic mat. Meanwhile , the water in the tank get down and the water indicator on . Slowly add water until the tank is full again and the water indicator light turns off . Full filled water could not overflow when screwing on the lid. (Note : water should not be spilled on the panel when adding water)



6 . Press the temperature key to set the temperature . It can be set to the temperature from 01 gear to 06 gear . When the setting temperature is less than the actual water temperature , the cooling function runs; and vice versa.

(Note: There is 6 gears of temperature display, and the led shows gear instead of temperature degrees. According the different ambient temperature, the lowest temperature can be reached at 12°C / 54°F, the highest temperature can be reached at 46°C / 116°F.

7 . The product should be used used at normal temperature not lower than 0°C If it needs to be used in the environment below 0°C , make sure that the water in the system does not freeze and the water goes smoothly.

How to Use

8 . Water will be consumed naturally during product use , add water when the low water level indicator light is flashing . (Note: If turn on the power and the device is not work, then check the water level indicator light, if light on/flashing, means lack of water, please add water immediately)

9 . When the product is not in use , drain the water from the control unit as well as the pad . Press the joint key and pull out the connector from the control unit . See figure 4.

10 . Drain water from the control unit : put the bigger end of the drain kit into the connect Port of the control unit , push it with a little force to release water . See figure 5.

11 . Drain water from the mat tube : put the smaller end of the drain kit into the tube connector , push it with a little force to release water . See figure 6.



Figure 1



Figure 2



Figure 3



Figure 4

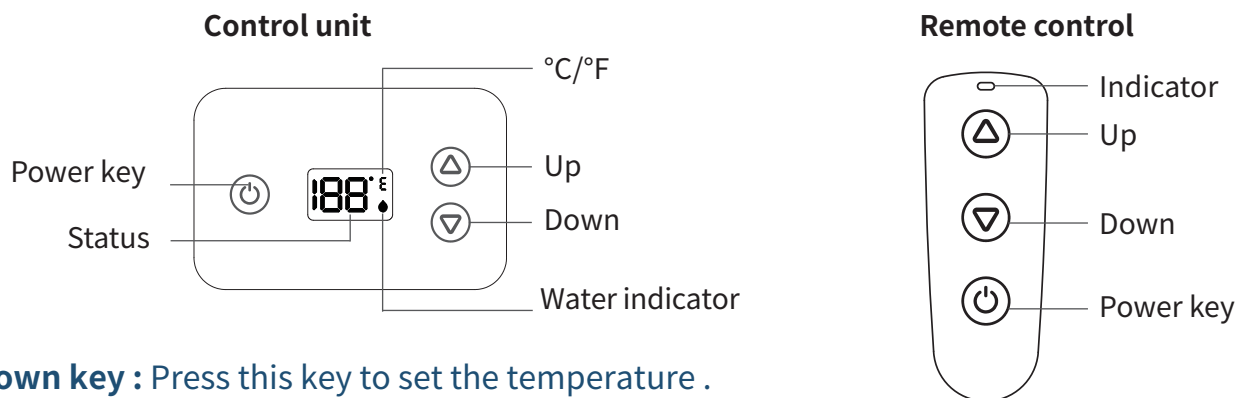

Figure 5



Figure 6

Keys presentation



Up / Down key : Press this key to set the temperature .

Power key : Press this button to turn on / off the device.

C / F conversion : Turn on the control unit , press and hold the power button on the remote for 5 seconds.

Water indicator : The indicator flashes when the water in the tank drops to the lowest position, please add water immediately .

(Note: ①) Turned on the power of control unit, fill the water into the tank until it full(highest level), and the indicator light will be off.

② The indicator light is always on, and the water level drops and it still can be used normally.

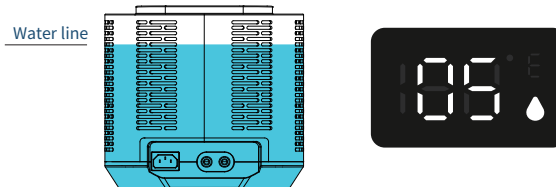
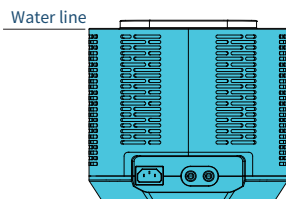

Keys presentation

③ When water at lowest level, the indicator light flashing, then need to be added water immediately. At the same time, the device will automatically shut down.

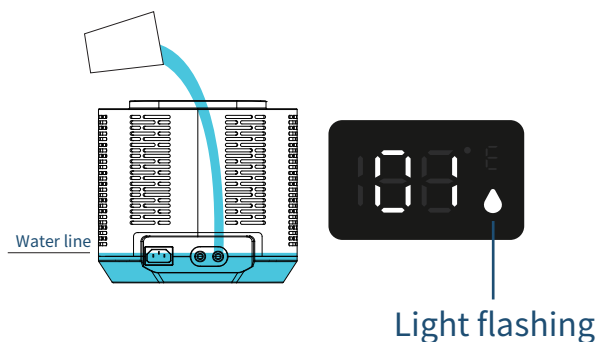

④ When adding water, it is necessary to turn on the control unit at the same time, otherwise the water in the mat may flow back into the water tank and overflow after opening the lid.)

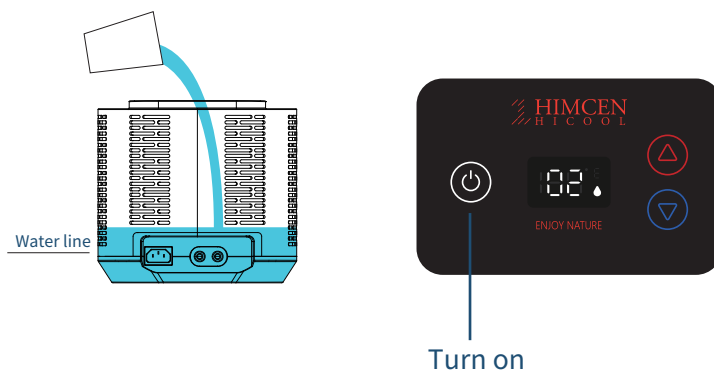

How to pair RC

Remote pairing : in the shutdown state , long press the power key on the control unit for more than 5 seconds , until the LCD screen are all displayed and flashing , press the power key on the remote control to make the pairing.

(**Note:** The Remote control has already matched before delivery)

Use tips

1. Set the right sleep temperature. Everyone has a unique and ideal sleep temperature, it is recommended to set different temperatures for experience, so as to find your ideal sleep temperature.
2. If you like getting into a cool or warm bed, set your desire temperature 30 minutes in advance to Pre-cool or heat up.
3. A blanket or quilt should be placed over your body when the HiCool mat is in use, to provide the needed insulation to achieve your desired temperature.
4. The temperature displayed on the control unit is the water temperature inside the water tank, there is a difference between the mattress topper temperature and the setting temperature. For example, at an ambient temperature of 25°C the setting temperature is 12-46°C, while the actual surface temperature of the mattress topper would be 18-42°C.
5. In many cases, the setting temperatures are not fully achieved due to ambient temperature, air humidity of the room, different sizes of the mat, and objects or walls near the control unit, etc.
6. Inspect the connection tube and cloth pad regularly for folding or sharp angles which would limit water flow, decreasing the system's ability to cool or heat.
7. Condensation is a natural result of warm and cold temperatures meeting. In the case of high humidity (> 70%), when there is a big difference between the setting temperature and the ambient temperature, condensate would be generated on the water tank and water tube. To avoid this, it is suggested that under the condition of high humidity, narrow the difference between the setting temperature and the ambient temperature to be at 3rd gear.

How to fill water

When the hydronic mat without water

Recommended to place the control unit on a flat place higher than the mat, First, full filled the water tank, then turn on the power, the water will run into the hydronic mat, and the water level indicator light on, continue to fill water until the light off, and screw the lid. then put the control unit to an airy position.

when the hydronic mat with water and the tank is at low water level:

1. When adding water to the water tank, it is recommended to place the control unit on a flat place higher than the mat, or on a place at the same level as the mat to prevent the tube water flowing back and overflowing.

2.a) When adding water at a position lower than the mat, take off the water pipe joint on the control unit end when the indicator light is flashing, then fill the water tank to the high position and tighten the cap. Then reconnect the pipes to start the device.

b) When adding water at a position lower than the mat, the control device must be turned on while the lid is open, meanwhile fill water into the tank, otherwise the water in the mat will flow back into the tank and overflow. Please pay close attention.

It is recommended to fill with normal temperature water, do not add frozen water or water with temperature higher than 45 degrees(113°F)

Safety Instructions

Read all instructions carefully before using this product:

1. Check that all accessories are available before operation.
2. Lay the HiCool mat flat and free from wrinkles before filling with water
3. The control unit should be placed on a flat support surface without sharp edge.
4. This product is not for use in hospitals.
5. Do not insert the sharp objects such as needles or nails into the air vents of the control unit.
6. Always unplug the machine from electrical outlet before cleaning.
7. Give close supervision when this machine is being used by / around children or disabled persons.
8. When children (infants), persons with disabilities, persons with reduced abilities, persons with reduced physical, sensory or mental capabilities, or persons who lack experience and knowledge or persons who are not sensitive to heat (such as persons with poor blood circulation) use this machine, close supervision are required.
9. Do not use the HiCool system with any other heated blanket, foot warmer or similar cooling or heating devices.
10. Make sure the power cable is far away from the HiCool mat, and the bedding is not in contact with the control unit.
11. Do not use the machine with the vents blocked, or in an environment with poor ventilation. Keep the air vent free from any debris like lint, hair and the like.
12. To disconnect, turn power off from control unit, then remove plug from outlet.
13. Do not use this product when the power cable, power plug is damaged or the control system fails.
14. Do not disassemble the product by yourself, as this will invalidate the warranty.
15. Children shall not play with the device.
16. Cleaning and user maintenance shall not be made by children without supervision.

Precautions & Warranty

1. Do not switch on if there is a possibility that the water in the device is frozen.
2. Appliance is obviously damaged must not be operated.
3. Disconnect the appliance from the power supply before carrying out maintenance.
4. Sharp objects such as needles and pins must not be inserted in vents;
5. Don't prick the TPU hydronic mat with needles or sharp thing.
6. Don't cover the bedding or cloth on the control unit.
7. Fill the water into the Hydronic pad slowly to remove as much air as possible from the mat water tube to avoid multiple refills during use.
8. There are four press stud on the four corners. it's easy to take the hydronic pad out and wash the outfit.

NOTE:

From the date of purchase, the full set of the device has one-year warranty, lifelong maintenance. The following are not included in the free services:

1. Product damage caused by improper use or storage by the user.
2. Product damage caused by non-maintenance personnel.
3. No valid proof of purchase, or it has been altered.
4. Product damage due to unstable voltage or beyond the specified range.
5. Product damage caused by failure to follow instructions.
6. The warranty has expired or is beyond the scope of the warranty.
7. Products that are disassembled by the user or not repaired by the company's maintenance outlets.